



# THE SOUTH CHILTERN CHORAL SOCIETY

If you, or anyone near you, is taken ill, First Aiders are there to attend if required and are seated in the Concert Hall.

## EMERGENCY EVACUATION PROCEDURE

If the alarm sounds, evacuate as quickly, quietly and as orderly as is practical.

Without placing yourself, or anyone else, at risk;-

- Leave the building by the nearest exit without taking extra time to collect possessions.
- Do not divert from the direct route to the “Muster Point” (meeting point).
- Assemble in Groups at the “Muster Point” to enable the attendance to be checked, and **DO NOT LEAVE THE “MUSTER POINT” OR SITE, UNLESS DIRECTED SO TO DO.**
- (leaving prior to being directed may lead to others risking their lives searching for you).
- Do not re-enter the building until instructed so to do.

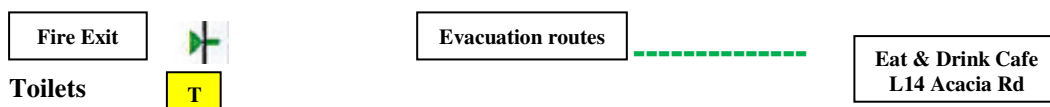
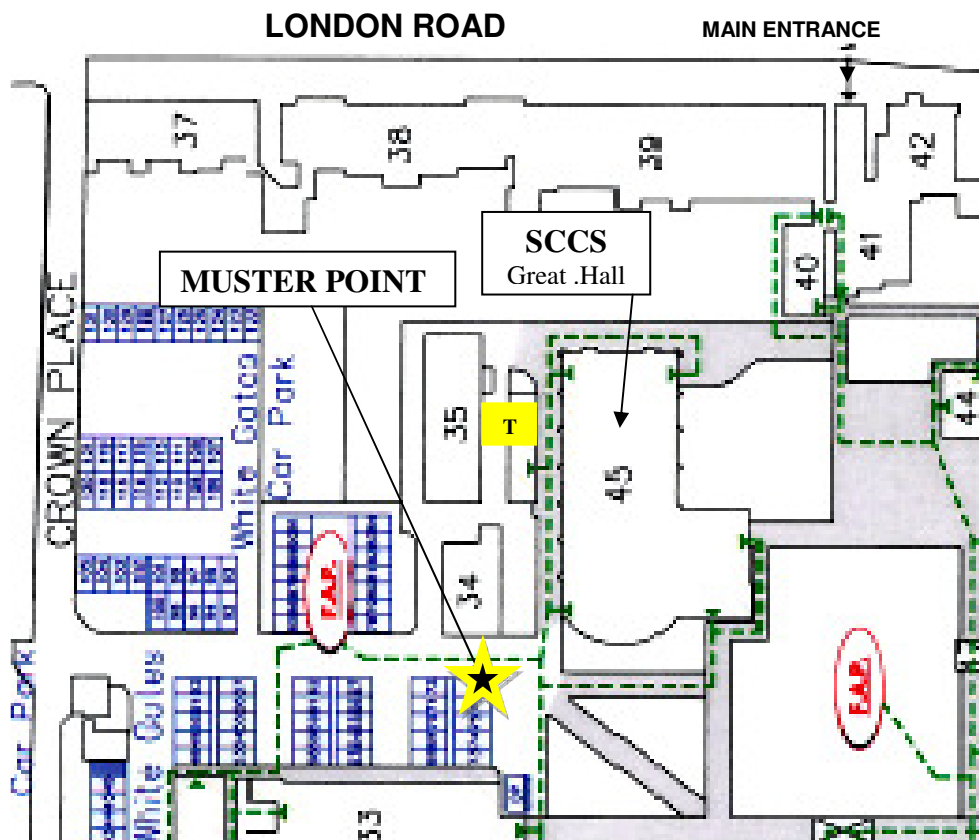

**SCCS REHEARSALS & CONCERT @ The GREAT HALL**  
Easter Concert 2016